

HEAT-SHRINKABLE SLEEVE INSTALLATION GUIDE

Equipment list



torch, roller, safety equipment :
gloves, goggles, etc.



460 Rue Perreault, Lévis, Qc, CAN, G6W 7V6
Tél/Phone : 418.839.6776
Télec/Fax : 418.839.7945
Courr/email : info@ipiinter.com
www.ipiinter.com

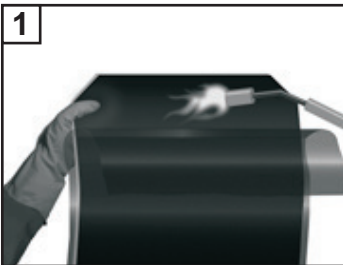

Partially remove the release liner and gently heat the underlap approximately 150 mm (6") from the edge.

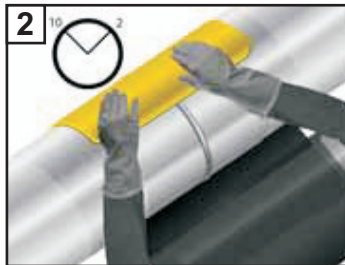

Centre the sleeve over the joint so that the sleeve overlaps between the 10 and 2 o'clock positions. Press the underlap firmly into place.

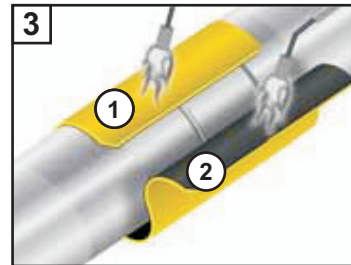

Wrap the sleeve loosely around the pipe, ensuring the appropriate overlap. Gently heat the backing of the underlap and the adhesive side of the overlap.

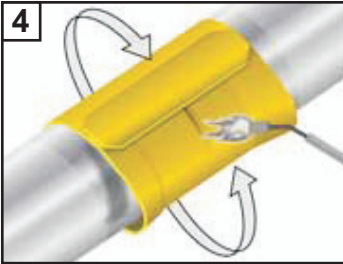

Using the appropriate torch, begin at the centre of the sleeve and heat circumferentially around the pipe. Use broad strokes. If utilizing two torches, operators should work on opposite sides of pipe.

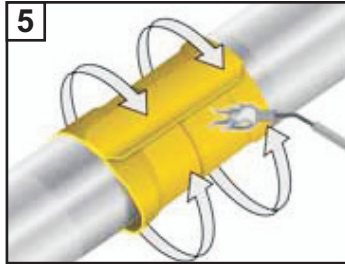

Continue heating from the centre toward one end of the sleeve until recovery is complete. In a similar manner, heat and shrink the remaining side.

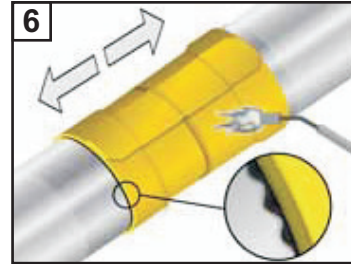

Shrinking has been completed when the adhesive begins to ooze at the sleeve edges all around the circumference. Finish shrinking the sleeve with long horizontal strokes over the entire surface to ensure a uniform bond.

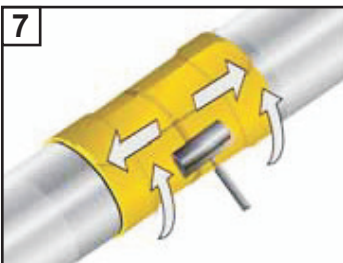

While the sleeve is still hot and soft, use a hand roller to gently roll the sleeve surface and push any trapped air up and out of the sleeve, as shown above. If necessary, reheat to roll out air.

Inspection

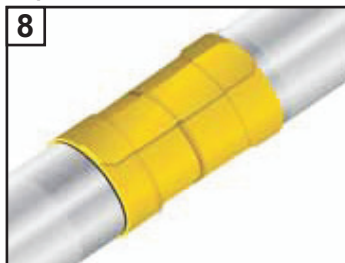

Visually inspect the installed patch for the following:
- Sleeve is in full contact with the steel joint;
- Adhesive flows beyond both sleeve edges;
- No cracks or holes in sleeve backing.